

Engaging the Video Generation

Dartfish

Invites its users and customers to participate in the 2008 Educators' User Conference at University of Bedfordshire

Thursday June 19th, 2008 – 10.00 to 17.00

User conference HIGHLIGHTS

Learn some new and exciting ways of using your Dartfish applications

Enjoy a mix of hands-on sessions and demonstrations, with experts from all over the country who have developed great expertise at integrating video and Dartfish.

Sessions cover

- > Experience sessions with hands-on activities
- > Mission sessions aimed at inspiring any teacher's and adviser's professional development
- > Questions and answers with Dartfish experts

Get inspired- Network with colleagues- Improve your ICT skills- Learn about what is coming next

What you need to know

- > Participate in the user conference for a low fee of £ 35.-
- > Each participant will receive a certificate of presence
- > Lunch, coffee and refreshments are included in your registration fee
- > Agenda, registration, details and map available below
- > Bring laptops if you wish to actively participate in some of the sessions

Please register by completing the form below

Dartfish reserves the right to cancel the User Conference in case of insufficient registrations (less than 30 by June 1st 2008).

2008 Dartfish Educators' user conference agenda

Thursday, June 19th, 2008

Schedule	Theme	Session details	Speaker/ Presenter
09.15-10.00	Welcome and registration		
10.00-10.30	Vision	How to enhance the integration of ICT in PE	Iain Stanger, LTS
10.45-11.30	Experience Session Using the storyboard to create interactive video projects.	You want to create projects that students can contribute to and then submit their work. Here is how to do it.	Neil Melville, Dartfish
10.45-11.30	Experience Session Have your students do a Mediabook in 90 seconds	You would like your students to submit GCSE project as a Mediabook format. Here is how to get them up to speed	Sebastien Dubuis, Dartfish
11.30-12.00	Networking-Coffee break		
12.00-12.45	Experience Session Making measurements from video. Focus on measuring tools	Sometimes the use of video is the easiest or only way to make measurements of distance, time or angles. Learn how to do this and record results in a DataTable or spreadsheet.	Neil Melville, Dartfish
12.00-12.45	Experience Session Creation of reference content	Dartfish offers so many ways of lining up content to be presented to the class	TBD
12.45-1.45pm	Lunch break		
1.45-2.30pm	Mission Session Create collaborative environment on the web	Use the web to publish, exchange content throughout the school	Iain Stanger, LTS

1.45-2.30pm	Mission Session Using Dartfish to assess elite performers	See how elite athletes benefit from the same technology you are using with your students	Stafford Murray, EIS
2.45-3.30pm	Mission Session Position yourself as an ICT specialist across your school	DF is empowering individuals to influence their colleagues across the curriculum	Matt Topliss, YST
2.45-3.30pm	Mission Session Using Dartfish to assess elite performers	See how elite athletes benefit from the same technology you are using with your students	Stafford Murray, EIS
3.30-4.00	Networking-Coffee break		
4.00-4.30pm	Plenary session wrap up		Paal Steensland, Dartfish
4.30-5.30	Optional: Q&A on Dartfish software	Opportunity for participants to ask technical questions	Neil Melville, Dartfish

We look forward to hearing from you and receiving your registration by June 1st 2008.
Please register by completing the form below

University of Bedfordshire map – Bedford Campus

as found on <http://www.beds.ac.uk/contactus/directions>

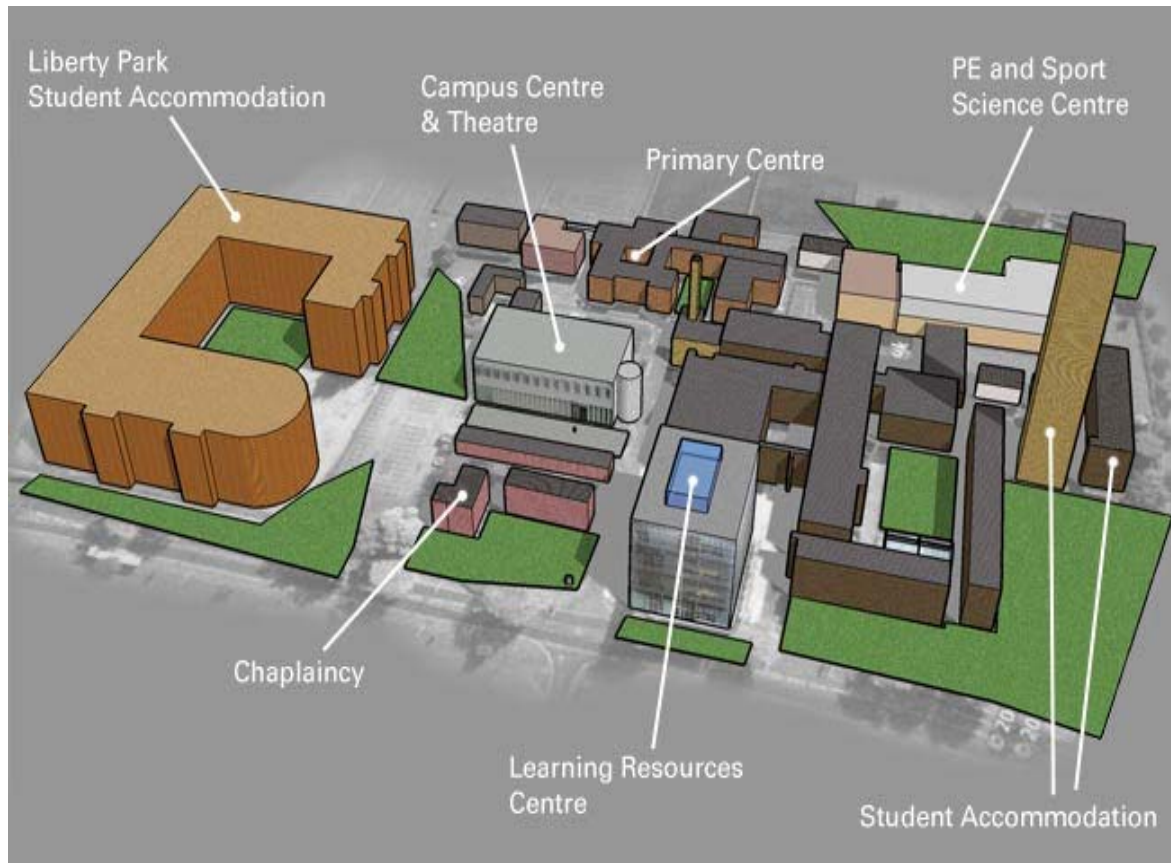

Directions

to University of Bedfordshire for Dartfish User Conference 2008

Bedford lies 50 miles north of London on the main A6 route. It is between the main north-south link roads, the M1 and the A1, offering easy access to the north and south of the country.

The campus is within walking distance of the train station (about 30 minutes) and there are always taxis available at the station.

By road

- **From the north**, leave the M1 at junction 14, then take the A422, following signs for Bedford.
- **From the south** leave the M1 at junction 13, then follow the A421 to Bedford.
- **From the A1**, south of St Neots, take the A428 to Bedford, Bedford campus is next to the A428 on the eastern side of Bedford.

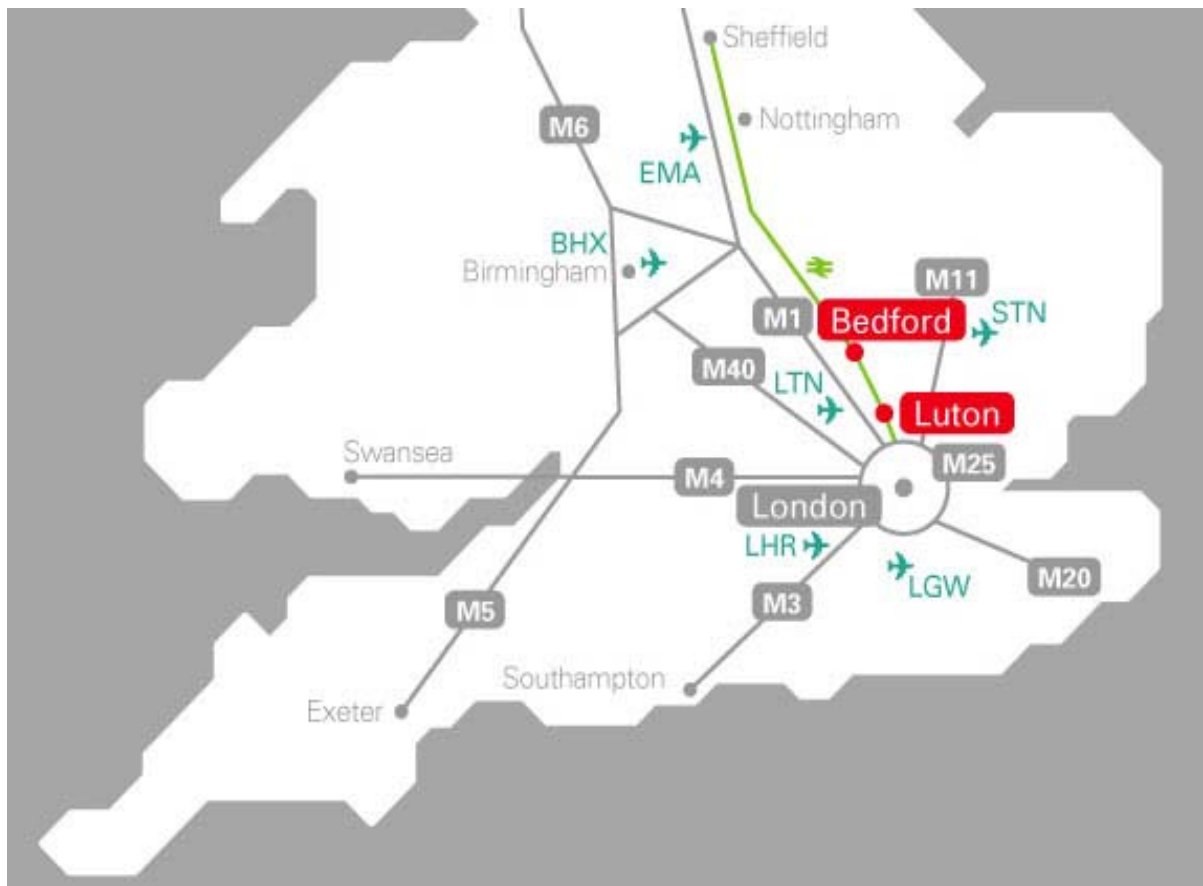

By rail

There are frequent trains, operated by **First Capital Connect** from London St Pancras International station - journey time about 50 minutes. **East Midlands Trains** run from London St Pancras station - journey time about 40 minutes. There are also **direct trains** from Leicester, Derby, Nottingham and Sheffield. Services to the West Midlands, Lancashire, and Scotland are via Milton Keynes.



2008 Dartfish Educators user conference - Registration Form –

- I will attend the Dartfish User Conference
- I won't be able to attend the Dartfish User Conference but I would like a representative to contact me

Full Name of Organisation : _____

First Names : _____

Last Names : _____

Job Title : _____

Address : _____

City : _____

Postcode : _____

Email address : _____

Phone Number : _____

Fax Number : _____

Please send this registration form by email info.uk@dartfish.com or fax 8701 302 352.

Payment of the registration fee (£ 35,- per participant) can be made on-site in cash, or through www.getdartfish.com.